

GRUNDRISS 1:1500

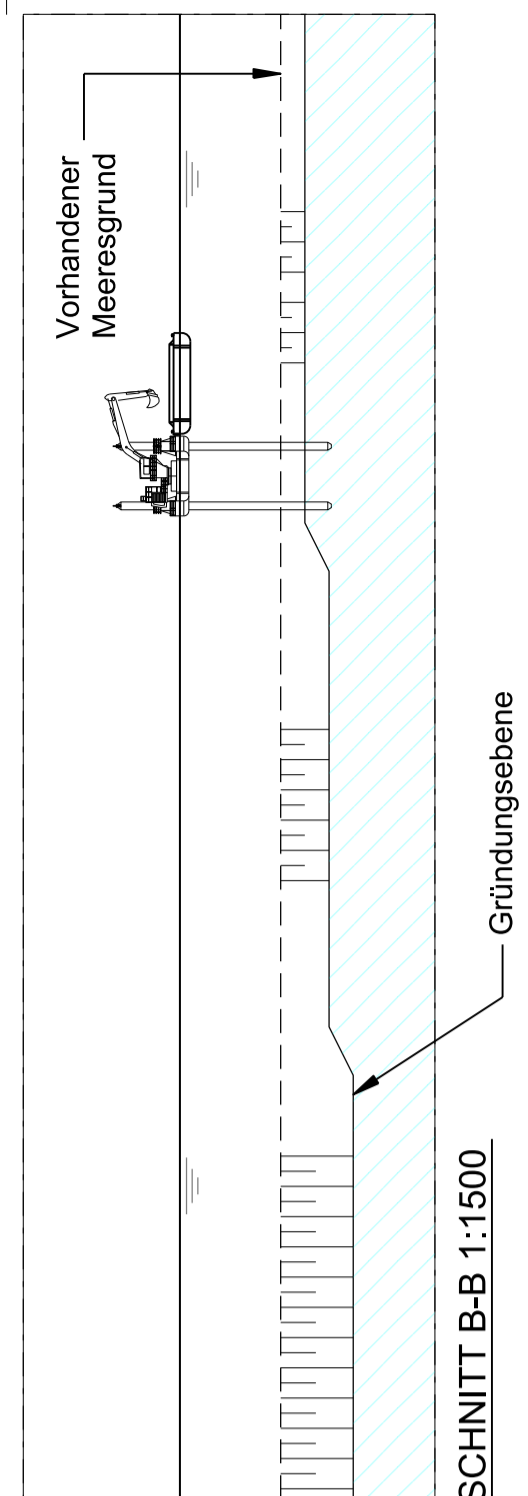

SCHNITT B-B 1:1500

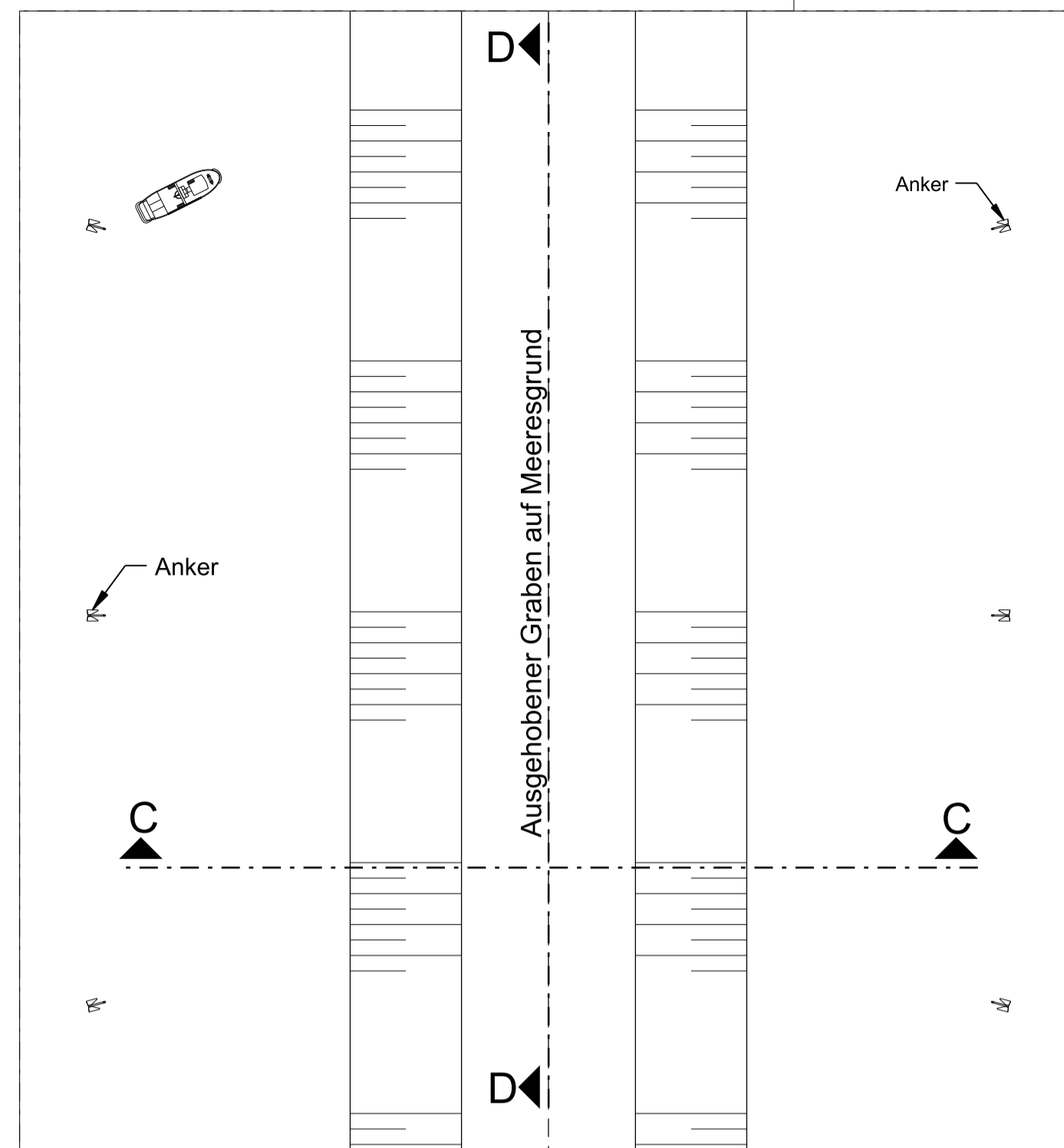

GRUNDRISS 1:1500



SCHNITT C-C 1:1500

BAUPHASE 2: ANKERMONTAGE

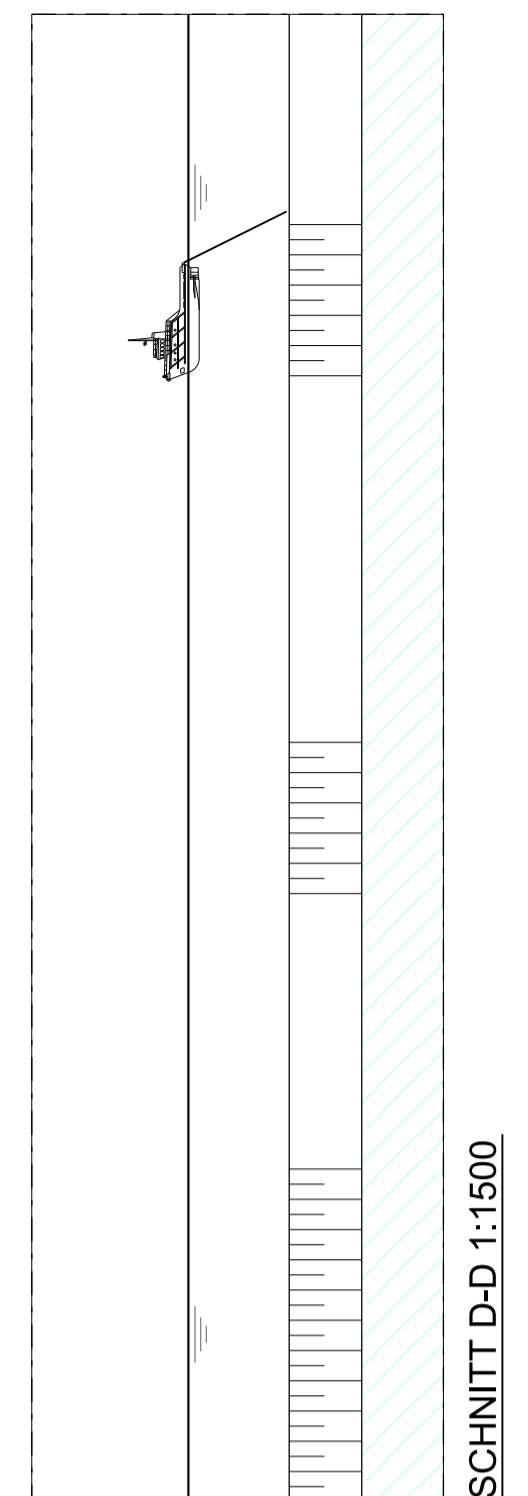

SCHNITT D-D 1:1500

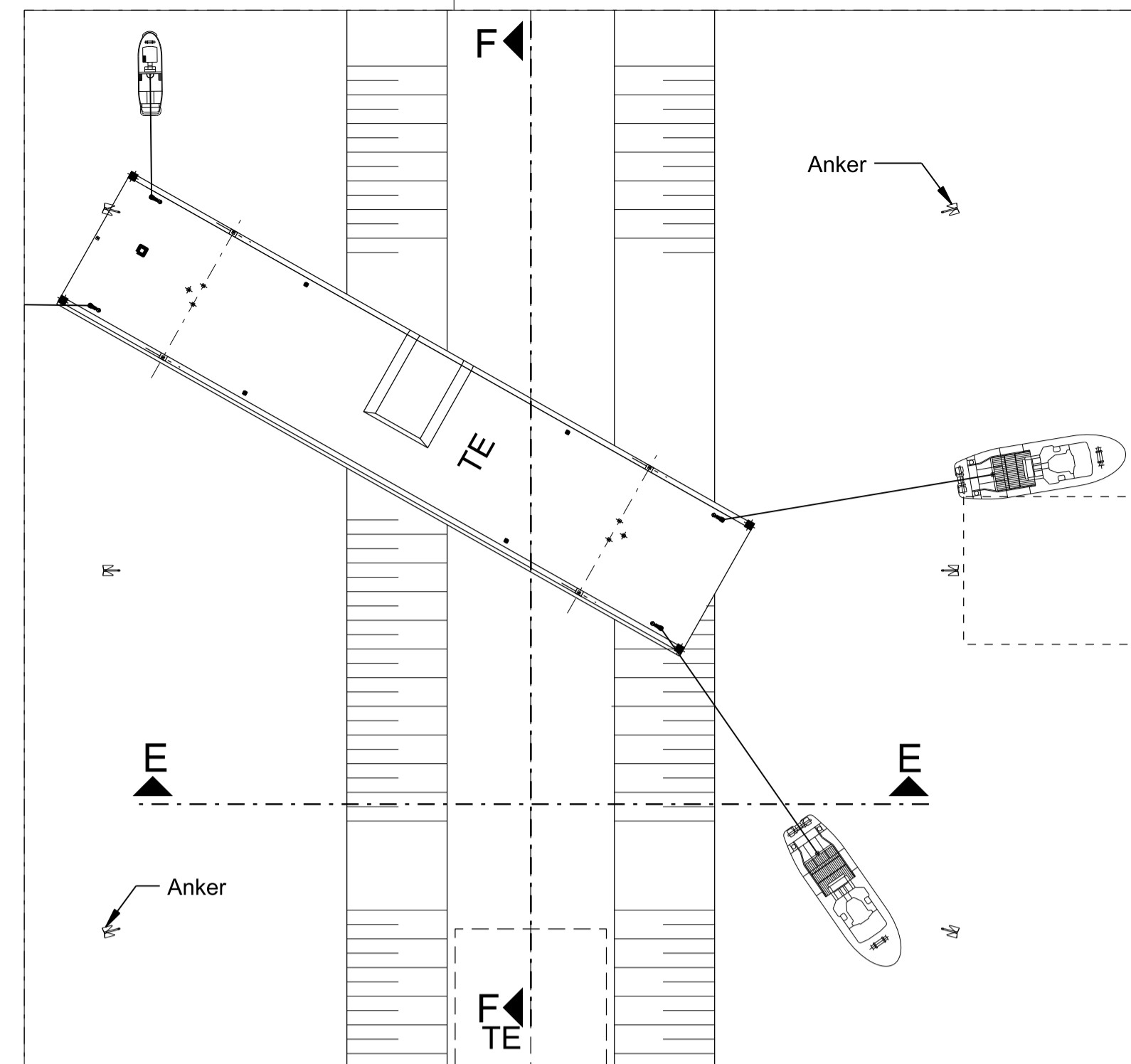

GRUNDRISS 1:1500

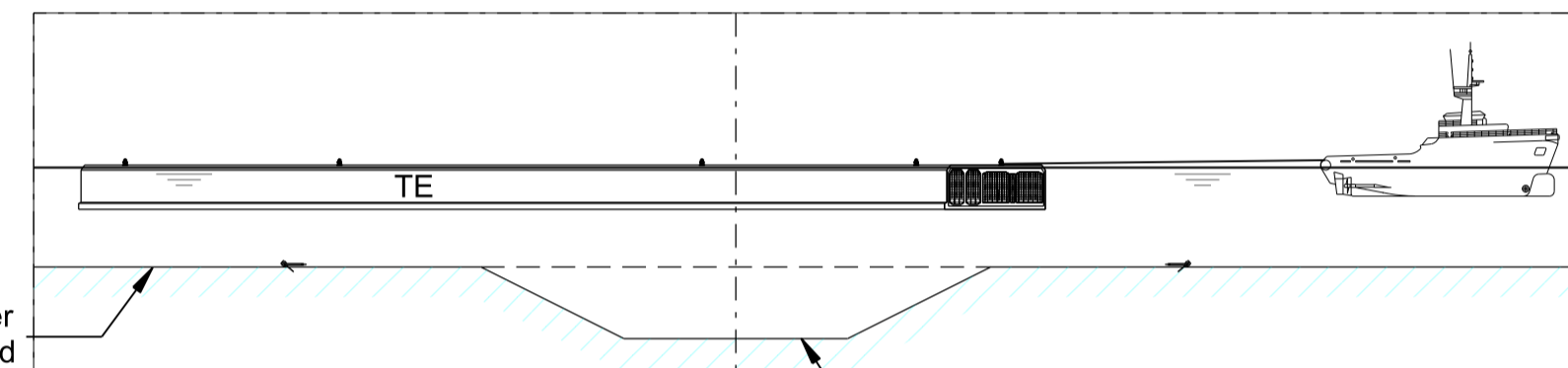

SCHNITT E-E 1:1500

BAUPHASE 3: SCHLEPPEN DES TUNNELLEMENTS (TE) ZUR BEREITSTELLUNGSPPOSITION

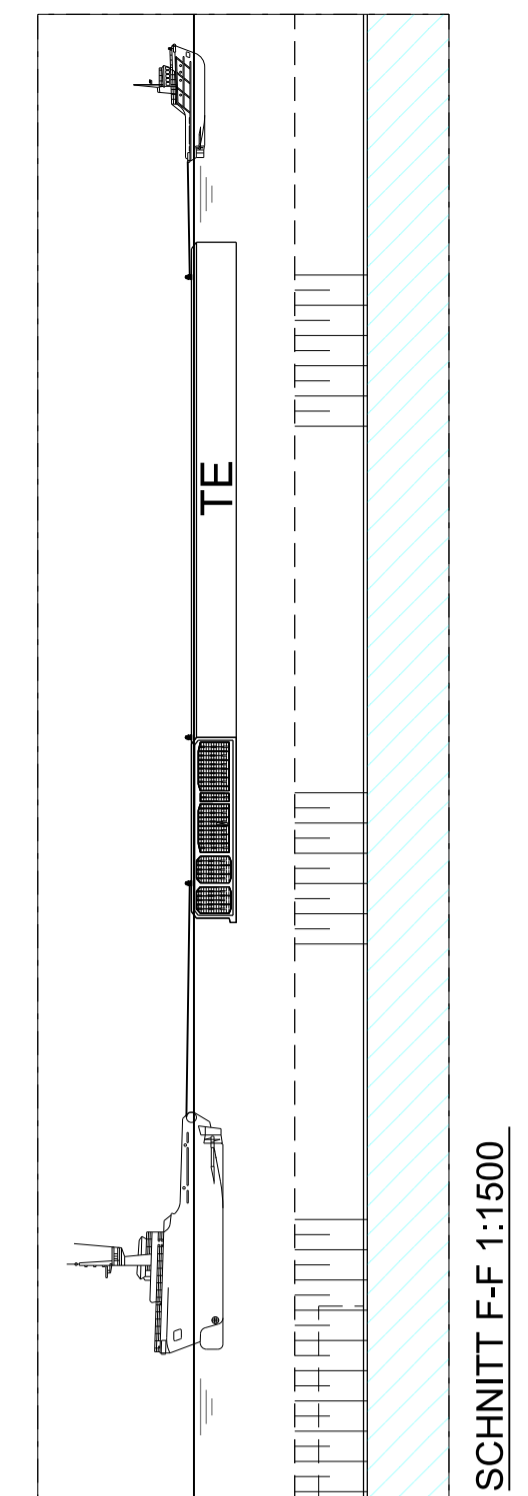

SCHNITT F-F 1:1500

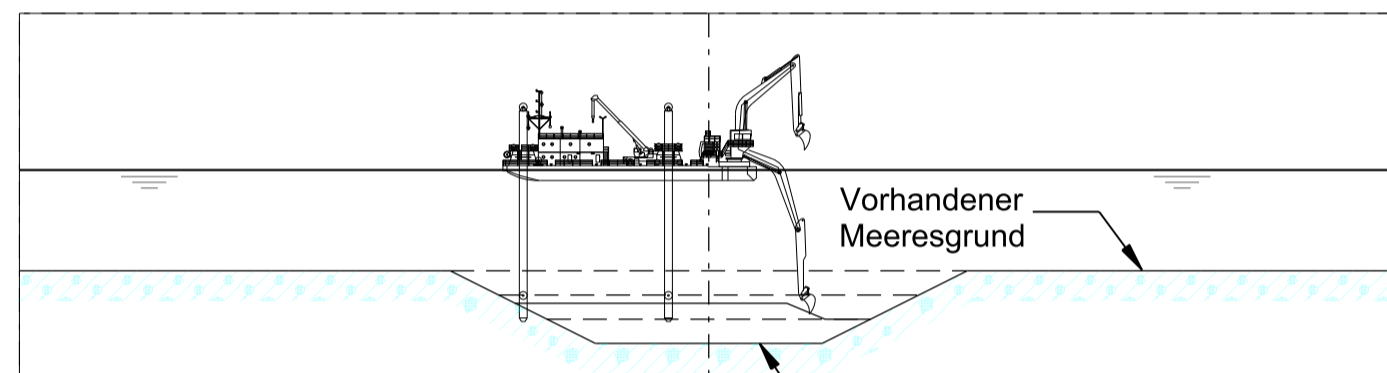

SCHNITT A-A 1:1500

BAUPHASE 1: GRABENAUSHUB

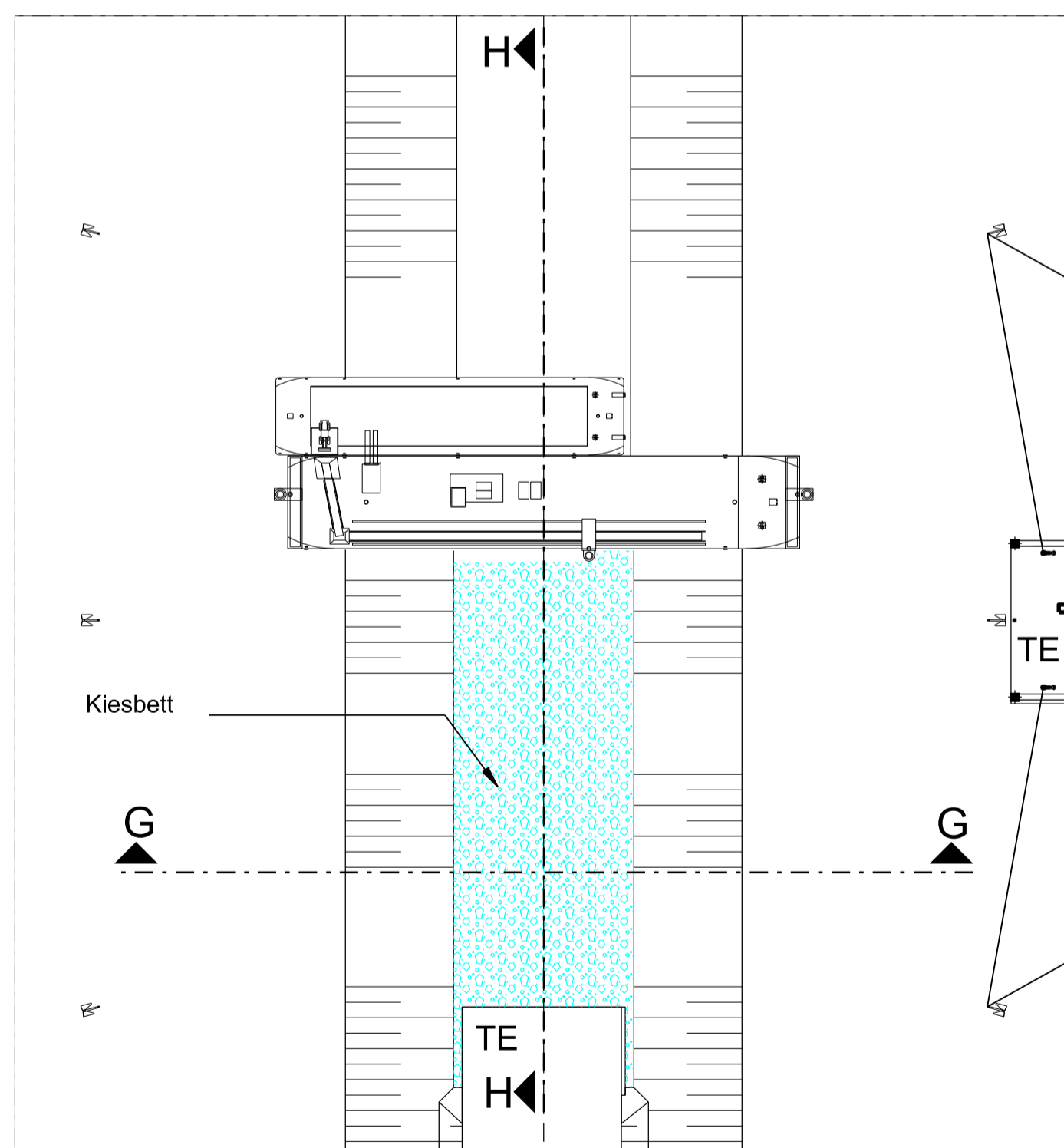

GRUNDRISS 1:1500

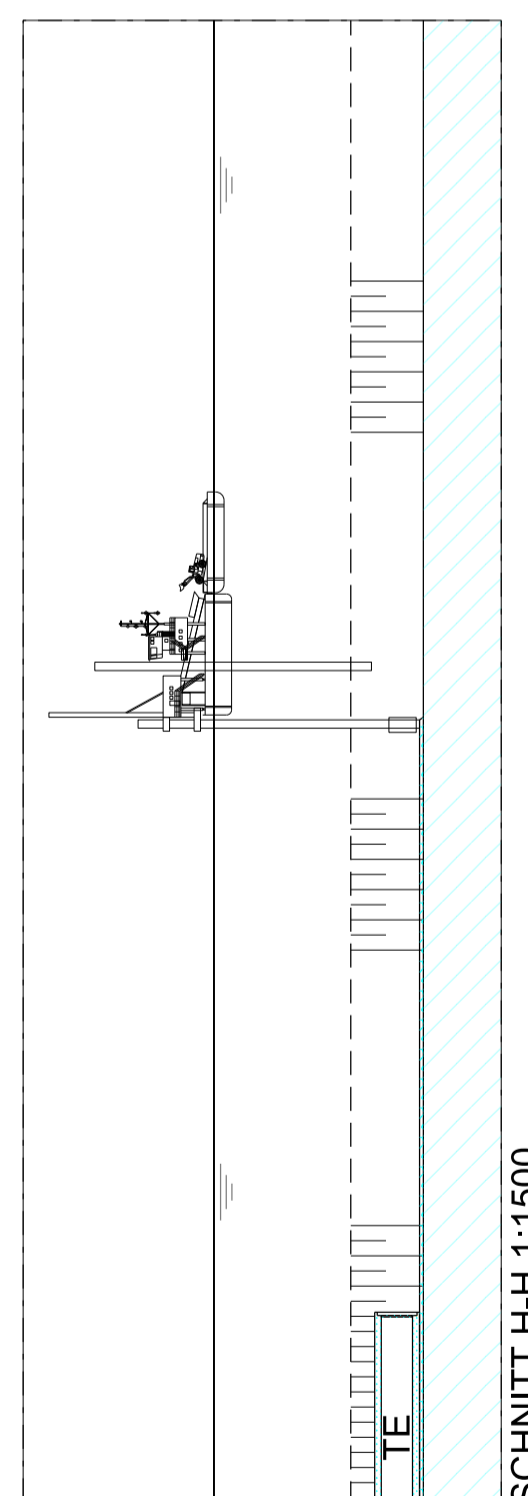

SCHNITT H-H 1:1500

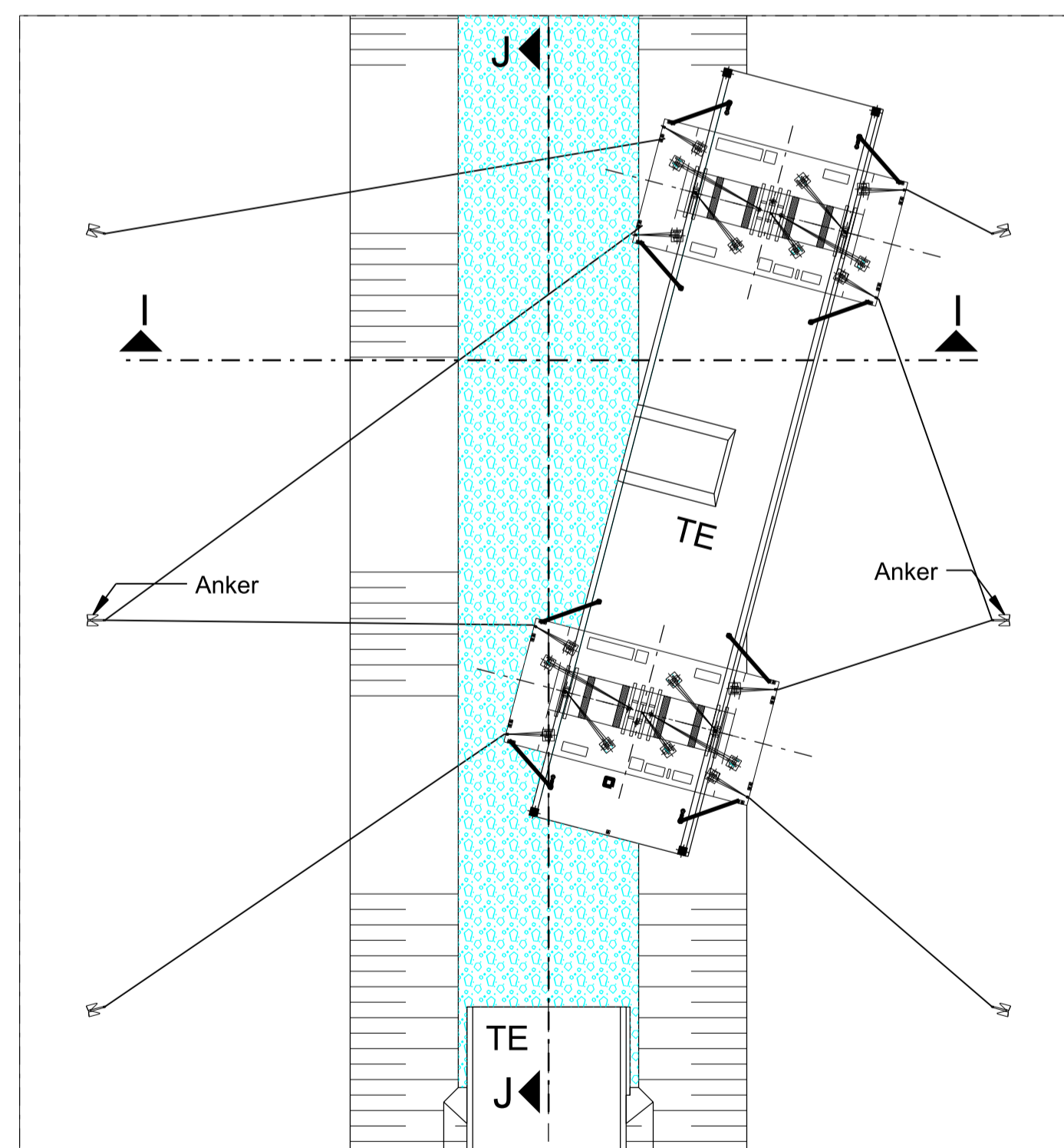

GRUNDRISS 1:1500



SCHNITT I-I 1:1500

BAUPHASE 5: POSITIONIEREN DES TUNNELLEMENTS (TE)

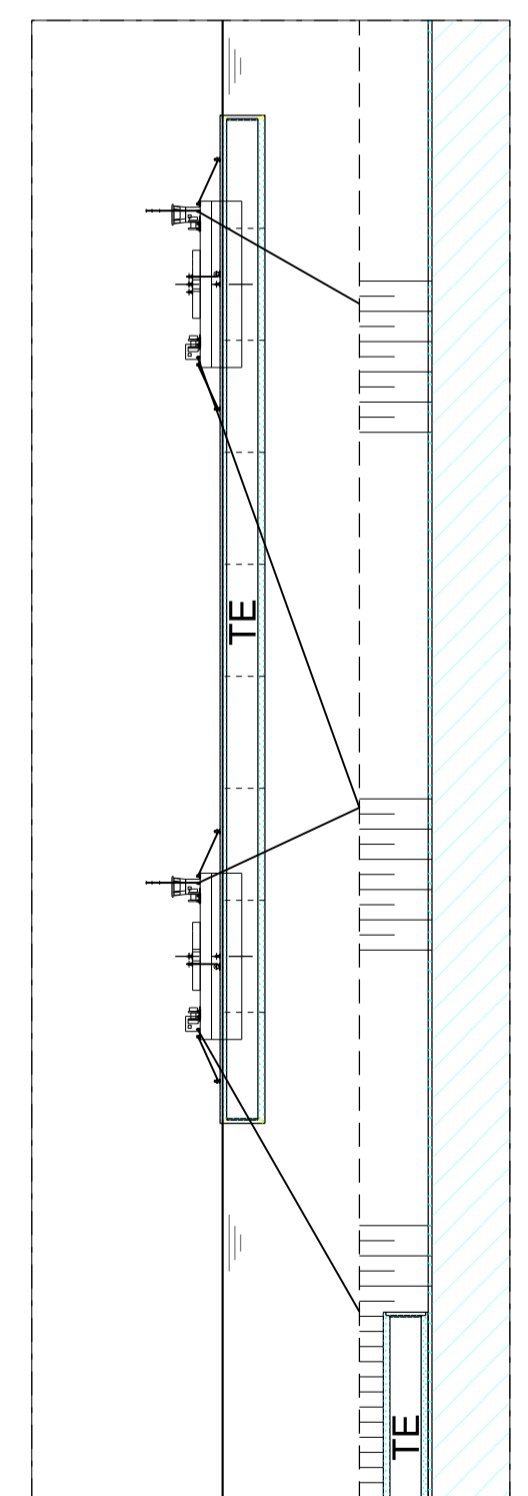

SCHNITT J-J 1:1500

**BEMERKUNGEN:**

TE = Tunnelement

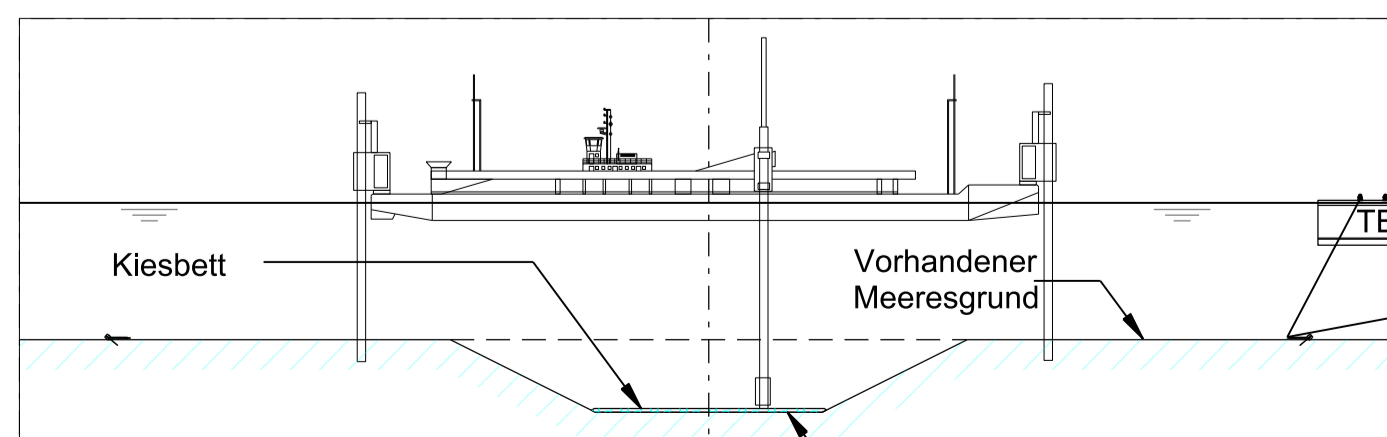

SCHNITT G-G 1:1500

BAUPHASE 4: SÄUBERUNG DES GRABENS UND EINBAU DES KIESBETTS

Planfeststellungsunterlage  
 Anlage 27.2, Blatt 1  
 Lagepläne  
 Wasserbau  
 Bauablauf Absenkvorgang Tunnel (1 von 2)

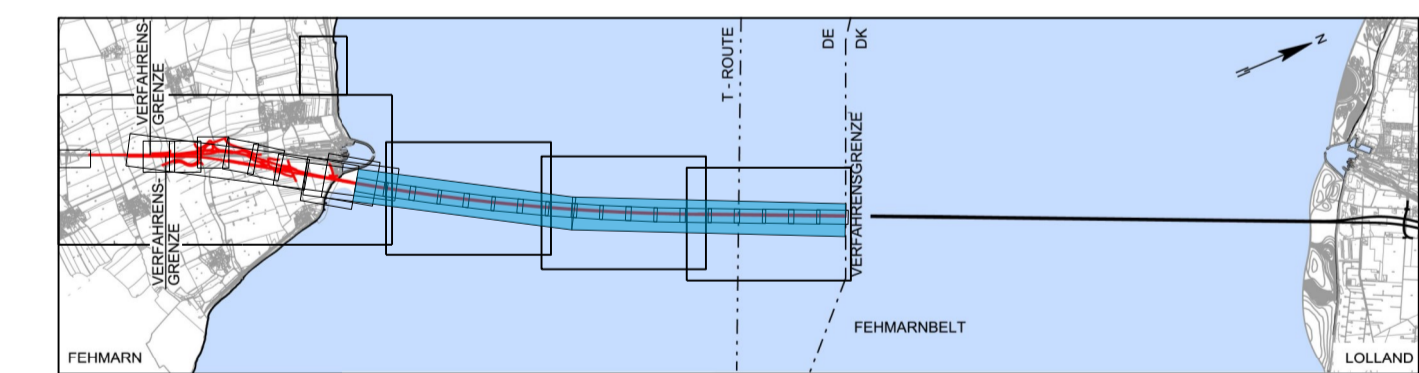

Index	Datum	Bearb./Gez.	Gepr.	Freig.	Art der Änderung

**Fehmarnbelt Fixed Link**  
 Plan Approval Document



gez. Claus Dynesen, 01.10.2013      gez. Torsten Conradt, 01.10.2013

Datum 2013-10-01	Bearb./Gez. PHX/INN	Gepr. EVP/HIL	Freig. gez. S. Pedersen	<b>RAMBØLL ARUP TEC</b>
Projekt Nr. 9594004	Maßstab 1:1500	Format A1	Index Datum 2014-02-14	C/o Rambøll Danmark A/S Hannemanns Allé 53 DK-2300 København S

Lagepläne	Bau-km (Bahn)	-
Wasserbau	Bau-km (Straße)	-
Bauablauf Absenkvorgang Tunnel (1 von 2)	Plan-Nr.	RAT-N-X11-0751

RAT-N-X11-0751